

# Green Pin<sup>®</sup> Super Shackles

up to 50% stronger than a standard shackle



## Improved model!

Old WLL		New WLL
50 tons	= >	55 tons
80 tons	= >	85 tons
110 tons	= >	120 tons
140 tons	= >	150 tons

**VAN BEEST**



your reliable partner

- Grade 8
- Meets performance requirements of US Federal Specification RR-C-271 Type IVA Class 3, Grade B
- WLL range from 3.3 ton up to 175 ton
- Can be recognized by, not only "Green Pin" but also, Green shackle "Crown"



VAN BEEST BV, Manufacturer/Supplier  
of wire rope and chain fittings  
Reg. trade mark 'Green Pin'

Recently new developments with our Green Pin® "Super" shackles have resulted in improved performance. We have upgraded the Working Load Limit of four sizes of shackles as follows: from 50 to 55, 80 to 85, 110 to 120 and 140 to 150 tons.

In order to distinguish the Green Pin® "Super" shackles from standard Green Pin® shackles the new model can be recognized by the Green painted shackle "Crown". Compared to standard Green Pin® shackles they have an up to 50% higher WLL with comparable physical weight and dimensions. These shackles are specially designed for applications where shackle weight and/or size are critical.

Please find herewith the latest Van Beest product information including details of these new shackles. For more information please contact us: [sales@vanbeest.nl](mailto:sales@vanbeest.nl)

## Green Pin® Super Shackles bow shackles with safety bolt

- **Material** : bow and pin alloy steel, Grade 8, quenched and tempered
- **Safety Factor** : MBL equals 5 x WLL
- **Standard** : meets performance requirements of US Fed. Spec. RR-C-271 Type IVA Class 3, Grade B
- **Finish** : hot dipped galvanized (175 ton shackle is painted)
- **Certificates** : at no extra charges this product can be supplied with a works certificate, certificate of basic raw material, manufacturer test certificate and EC Declaration of Conformity. All shackles starting from 150 tons are supplied with a Lloyd's Register of Shipping Certificate on proof load

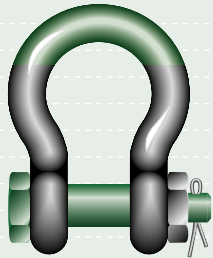

G-5263

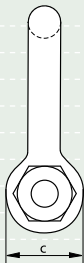
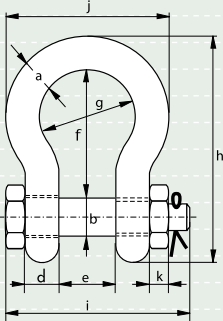

working load limit	diameter bow	diameter pin	diameter eye	width eye	width inside	length inside	width bow	length bow	length bolt	width bolt	thickness nut	weight each
tons	a	b	c	d	e	f	g	h	i	j	k	kg
3.3	13.5	16	34	13.5	22	51	32	91	81	63	11	0.44
5	16	19	40	16	27	64	43	114	99	79	17	0.79
7	19	22	47	19	31	76	51	136	115	94	20	1.26
9.5	22	25	53	22	36	83	58	157	131	107	23	1.88
12.5	25	28	60	25	43	95	68	176	151	124	25	2.78
15	28	32	67	28	47	108	75	197	167	137	28	3.87
18	32	35	74	32	51	115	83	218	179	154	31	5.26
21	35	38	80	35	57	133	92	240	198	170	34	6.94
30	38	42	89	38	60	146	99	262	203	183	19	8.79
40	45	50	104	45	74	178	126	314	244	226	24	15
55	57	57	133	50	83	197	138	365	269	264	27	22.0
85	70	70	159	65	105	260	180	468	330	339	33	42.0
120	83	83	171	75	127	330	190	564	399	371	40	70.0
150*	95	95	215	89	144	381	238	667	440	416	50	112
175*	105	108	245	100	165	400	275	702	490	485	60	160

\* = round headed bolt

In inch

working load limit	diameter bow	diameter pin	diameter eye	width eye	width inside	length inside	width bow	length bow	length bolt	width bolt	thickness nut	weight each
tons	a	b	c	d	e	f	g	h	i	j	k	lbs
3.3	1/2	5/8	1 11/32	17/32	7/8	2	1 9/32	3 19/32	3 3/16	2 1/2	7/16	0.97
5	5/8	3/4	1 19/32	5/8	1 3/32	2 17/32	1 23/32	4 1/2	3 29/32	3 1/8	11/16	1.74
7	3/4	7/8	1 7/8	3/4	1 1/4	3	2	5 11/32	4 17/32	3 3/8	25/32	2.78
9.5	7/8	1	2 3/32	7/8	1 7/16	3 9/32	2 9/32	6 5/32	5 5/32	4 3/16	29/32	4.14
12.5	1	1 1/8	2 11/32	1	1 23/32	3 3/4	2 11/16	6 29/32	5 15/16	4 7/8	1	6.13
15	1 1/8	1 1/4	2 5/8	1 1/8	1 7/8	4 1/4	2 15/16	7 3/4	6 19/32	5 3/8	1 1/8	8.53
18	1 1/4	1 3/8	2 29/32	1 9/32	2	4 17/32	3 9/32	8 9/16	7 1/32	6 3/32	1 1/4	11.6
21	1 3/8	1 1/2	3 5/32	1 3/8	2 1/4	5 1/4	3 5/8	9 7/16	7 25/32	6 23/32	1 11/32	15.3
30	1 1/2	1 5/8	3 1/2	1 17/32	2 11/32	5 3/4	3 29/32	10 5/16	8	7 3/16	3/4	19.38
40	1 3/4	2	4 1/8	1 25/32	2 29/32	7	4 15/16	12 11/32	9 19/32	8 29/32	15/16	33.07
55	2 1/4	2 1/4	5 1/4	2	3 9/32	7 3/4	5 7/16	14 3/8	10 19/32	10 3/8	1 3/32	48.50
85	2 3/4	2 3/4	6 1/4	2 9/16	4 1/8	10 1/4	7 9/32	18 3/8	13	13 5/16	1 5/16	92.59
120	3 1/4	3 1/4	6 3/4	2 15/16	5	12 15/16	7 1/2	22 3/16	15 3/4	14 5/8	1 19/32	154.32
150*	3 3/4	3 3/4	8 1/2	3 17/32	5 11/16	15	9 11/32	26 9/32	17 5/16	16 3/8	2	246.92
175*	4	4 1/4	9 5/8	3 15/16	6 17/32	15 3/4	10 13/16	27 5/8	19 9/32	19 1/8	2 3/8	352.74

\* = round headed bolt

VAN BEEST BV  
P.O. Box 57  
3360 AB Sliedrecht  
The Netherlands  
Industrieweg 6  
3361 HJ Sliedrecht  
Telephone +31 184 41 33 00  
Telefax +31 184 41 49 59  
E-mail [sales@vanbeest.nl](mailto:sales@vanbeest.nl)  
Internet [www.vanbeest.nl](http://www.vanbeest.nl)



Date: January 16, 2006  
Update: 2006-0101

